

- Beginning Poplar
- N 75 E 30 to Locust
- N 55 E 20 to Beech
- N 4 W 7 to Sugar Tree
- On Lost Creek and Down Scutte
- N 46 W 22-
- N 59 W 30-
- N 59 W 100-
- N 70 W 25-
- S 70 W 16-
- N 74 W 74-
- S 11 E 32-
- S 15 W 25-
- S 66 W 26-
- S 55 W 58-
- S 11 W 34-
- S 4 W 22- to Black Oak
- and By Vacant Land
- S 52 E 16- to Dogwood
- N 56 E 76 to White oak
- S 74 E 28 to White Oak
- S 53 E 149 to Beginning

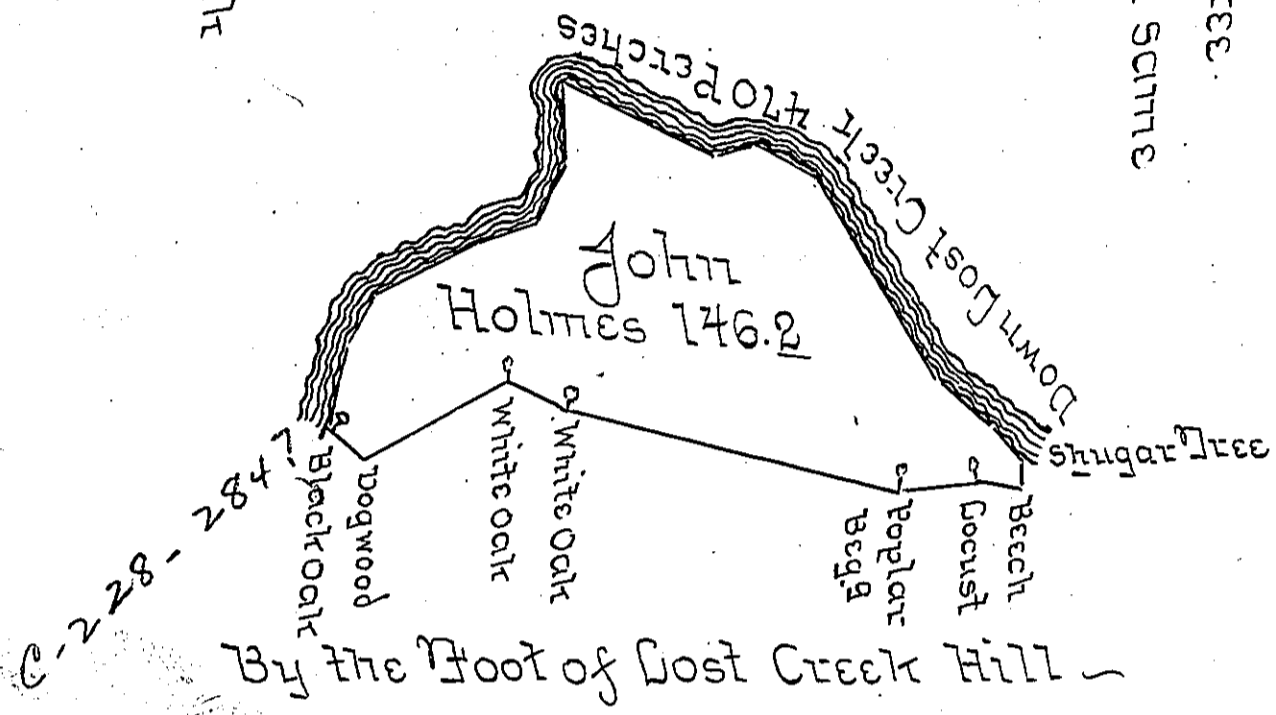

The Draught of a Tract of Land called \_\_\_\_\_  
 situate on (obl) South side of Lost Creek (obl) the County of  
 Cumberland containing One Hundred Forty six acres  
 36 Perches with the usual Allowance of Six Acres &  
 Cent for Roads. Surveyed the 21<sup>st</sup> day of January  
 Anno Dom: 1769 in Pursuance of an Order of Survey  
 to John Holmes Bearing Date at Philad<sup>a</sup> the 8<sup>th</sup> day  
 of August Anno Dom: 1766 and N<sup>o</sup> 815-

P. Wm MacLay U.S.

To John Lukens Esq<sup>r</sup> S. J.  
 of Pennsylvania

IN TESTIMONY that the above is a copy of the original remaining on file in  
 the Department of Internal Affairs of Pennsylvania, made  
 conformably to an Act of Assembly approved the 16th day of  
 February, 1833, I have hereunto set my Hand and caused  
 the Seal of said Department to be affixed at Harrisburg,  
 this eighteenth day of January 1906.

*Loach R. Brown*  
 Secretary of Internal Affairs.